

FN1SXF OptiClean™ Negative Air Machine and Scrubber



Product Data



Fig. 1 – OptiClean™ Negative Air Machine

The OptiClean™ negative air machine is a portable solution primarily designed to help convert normal hospital rooms into Airborne Infectious Isolation (AII) rooms. Designed to ASHRAE's Standard 170 for Ventilation of Health Care Facilities, the OptiClean™ uses highly efficient filters and a heavy duty, yet quiet, motor to remove contaminated air from the room. The resulting negative air pressure, or "vacuum effect," helps limit the spread of air-based contaminants into surrounding areas. If negative pressure is not required, such as in an open-air, temporary hospital, the machine can be used as an air "scrubber," pulling air in, removing many contaminants, and discharging cleaner air back into the room.

The unit can be operated either vertically as shown, or horizontally.

The OptiClean™ negative air machine is currently designed for commercial applications only.

STANDARD FEATURES

- Pre-filter pleated synthetic material, MERV 7
- 99.97% efficient long-life HEPA H13 filter
- Nominal airflow 500 CFM
- Meeting ASHRAE Standard 170: Ventilation of Health Care Facilities
- Vertical design for smaller footprint compared to many competitors, and can be mounted and operated horizontally when necessary
- Portable and adaptable to nearly any location
- Heavy duty locking casters for easy and smooth transport
- HEPA filter mounting and seal test to meet filter air by-pass Class F9 EN 1886
- Red lighted indicator to alert user when filters are overloaded (generally means pre-filter requires replacement)
- Green ON/OFF switch illuminates to verify when running
- 3 meters long power cord with strain relief
- Power cable access from rear of the unit
- Type G plug optional
- 230V / 50hz / 60hz / 1Ph Power
- Chassis is made from galvanized steel, pre-painted and fully insulated
- Exhaust transition plate to standard 10-inch round
- One year limited warranty



Fig. 2 – Room Setup Example

Model Number Nomenclature

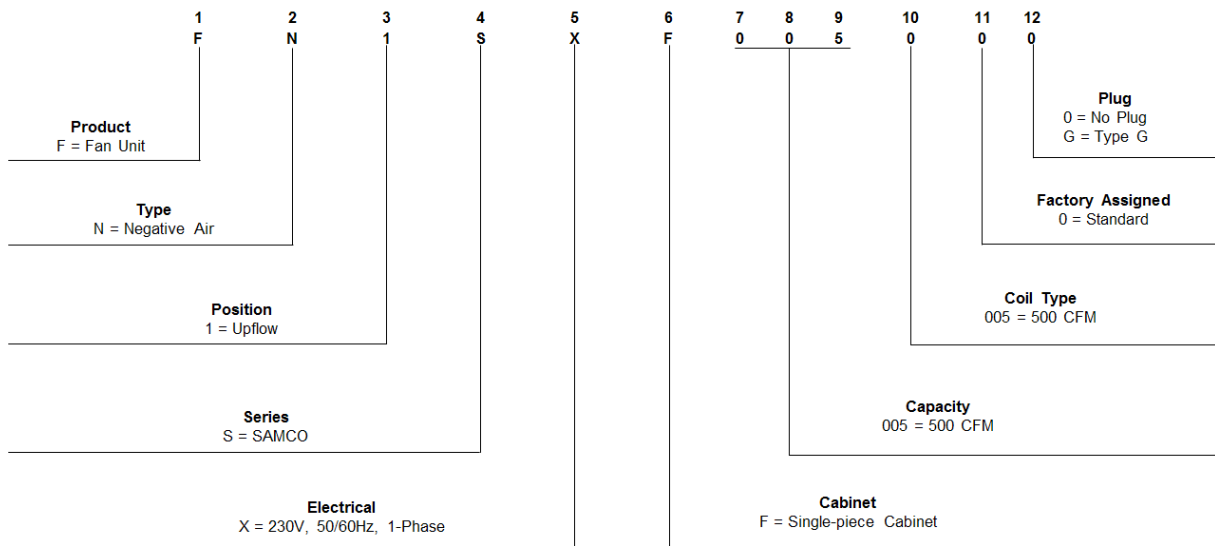

FN1SXF Specifications

Model Size	005
Unit Net Dimensions – cm (H* x W x D)	126.0 x 44.5 x 56.0
Unit Net Operating Weight - kg	63.0
Unit Packing Dimensions – cm (H x W x D)	137.0 x 49.0 x 63.0
Unit Packing Weight - kg	64.0
Air Discharge	Vertical
Blower Type	Forward DIDW
Nominal CFM	500
Motor Type	Electronically Commutated Motor
Motor HP	1/2
Factory Installed Pre Filter	Synthetics Pleated MERV 7 - (16" x 20" x 2")
Factory Installed HEPA Filter	HEPA H13 - (16" x 20" x 12")
Voltage	230V
Hertz	50/60
Amps	3.8

*. Height without casters. Add 10 cm height when casters installed

FN1SXF Sound Data

	Sound Power, Lw								Overall Lp Sound Power		Overall Lp Sound Pressure	
	dB	dB	dB	dB	dB	dB	dB	dB	dB	dBA	dB	dBA
	63	125	250	500	1000	2000	4000	8000	dB	dBA	dB	dBA
Re-circulating Air	79.0	78.0	75.0	72.0	73.0	71.0	68.0	66.0	83.7	77.9	69.2	63.4
Negative Air	71.0	70.0	59.0	53.0	52.0	44.0	39.0	32.0	73.8	58.3	59.2	43.8

Note: Sound Pressure level at 1.5 meter distance, ESP = 0° (Re-circulation), ESP = 0.6° (Negative Unit)

FN1SXF Airflow Curve

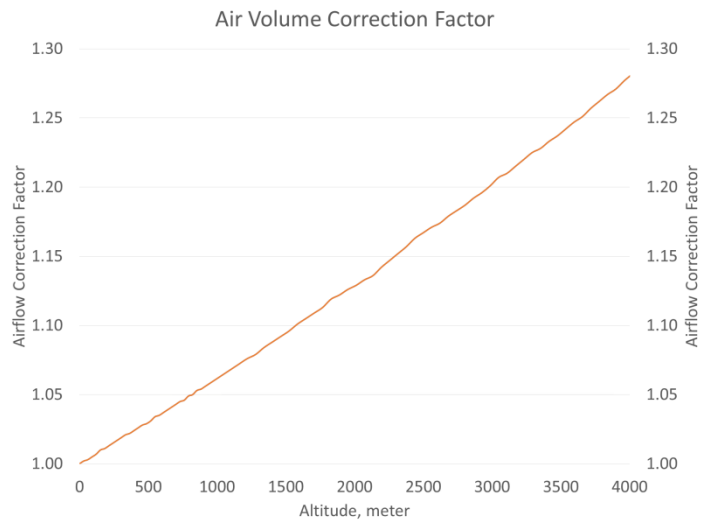
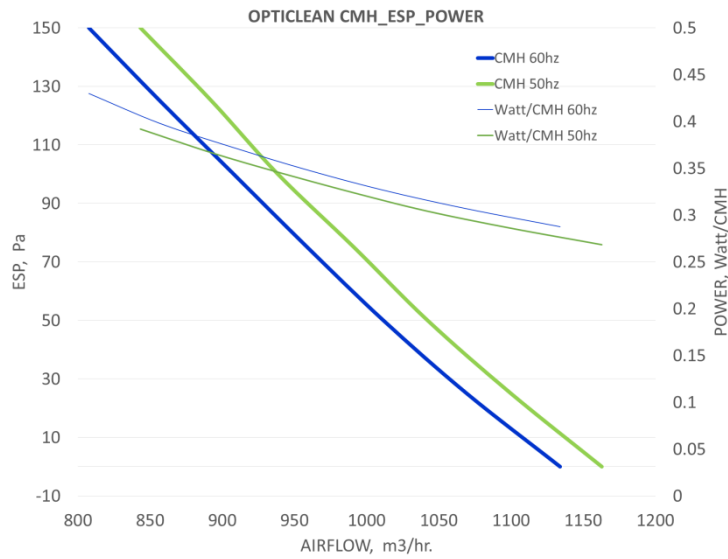
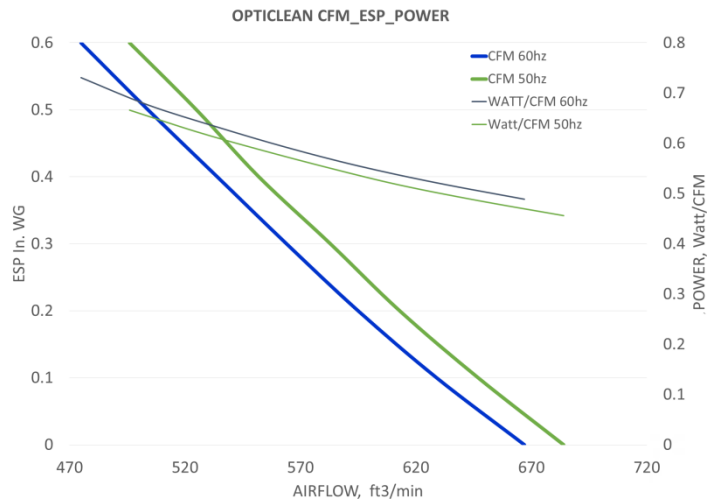

Note: Airflow performances curve with factory installed filters (MERV 7 and HEPA H13), 230V, without duct.

FN1SXF Dimensions

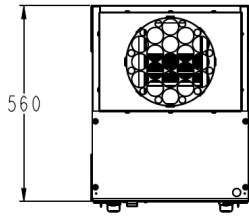

TOP VIEW (500CFM)

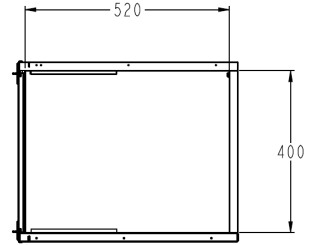
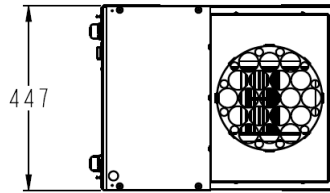

BOTTOM VIEW

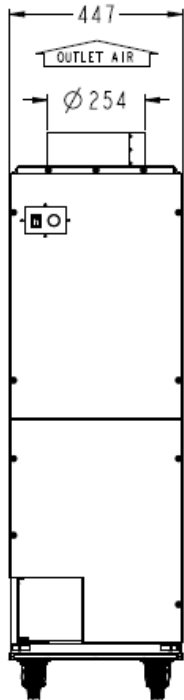

FRONT VIEW

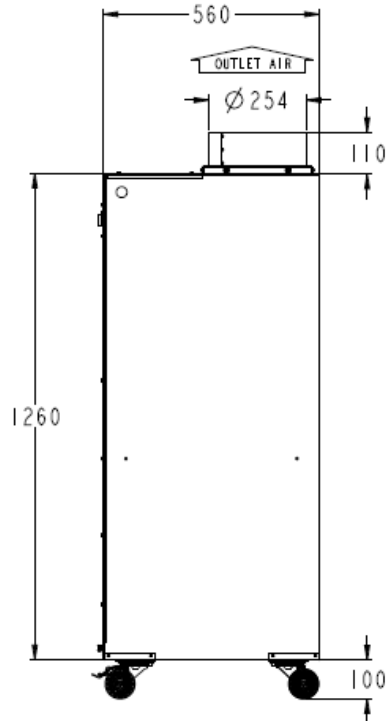

RIGHT SIDE VIEW