

Technical specifications

Indoor Unit		Unit	COOL ONLY		
			42KTD024HSFN	42KTD036HSFN-1	42KTD048HSFN-1
Unit Size		TR	2.0	3.0	4.0
Rating Capacity at T1 condition	Cooling	BTU/h	24,000	38,000	50,000
Rating Capacity at T3 condition	Cooling	BTU/h	21,200	33,500	43,500
Power Supply		V-Ph-Hz	380-415V~1-50		380-415V~3-50
Total Power Input* (Indoor + Outdoor)	Cooling	Watts	2,000	3,150	4,000
EER at T1		Btu/W.h	12.00	12.06	12.50
EER at T3		Btu/W.h	8.83	8.86	8.88
Total Current Drawn* (Indoor + Outdoor)	Cooling	A	8.9	16.0	8.4
Air Filter type			Nylon fibre filter		
Air Flow Rate (High/ Medium/ Low speed)		CFM	748 / 644 / 527	1205 / 1048 / 858	1490 / 1380 / 1260
Indoor Sound pressure Level (High/ Medium/ Low speed)		dBA	47 / 44.5 / 42	55 / 51 / 46	57 / 55 / 53
Net Weight (Body)		Kg	26.7	29.1	34.4
Net Weight (Panel)		Kg	5		5.8
Dimensions (W x D x H) (Body)		mm	840 x 840 x 245	840 x 840 x 287	910 x 910 x 287
Dimensions (W x D x H) (Panel)		mm	950 x 950 x 55		1020 x 1020 x 50
Pipe Connection Size	Liquid	inch	3/8"		
	Suction	inch	5/8"	3/4"	
	Drain	inch	3/4"		
Outdoor Unit		Unit	COOL ONLY		
			38KTD024HSFN	38KTD036HSFN-1	38KTD048HSFN-1
Power Supply		V-Ph-Hz	380-415V~1-50		380-415V~3-50
Compressor Type			Rotary	Scroll	
Refrigerant			R410A		
Pipe Connection Size	Liquid	inch	3/8"		
	Suction	inch	5/8"	3/4"	
Recommended Wire Size/No. of wires for Power Supply to CDU or IDU		mm² / qty	2.5mm²/2 + 1 Earth (CDU) 1.0mm²/2 + 1 Earth(IDU)	4.0mm²/2 + 1 Earth(ODU) 1.0mm²/2 + 1 Earth(IDU)	2.5mm²/4 + 1 Earth(ODU) 1.0mm²/4 + 1 Earth(IDU)
Recommended Wire Size/No. of wires for Control from FCU to Condensing Unit			1.0mm²/2 + 1 Earth		
Dimensions (W x D x H)		mm	946 x 410 x 810	900 x 350 x 1170	952 x 415 x 1333
Net Weight		Kg.	58.7	92.5	103.4
Max Outdoor Air temperature operation		°C	52		

1. T1 conditions: Indoor Air Temperatures 27°C (DB) / 19°C (WB) and Outdoor Air Temperatures 35°C (DB) / 24°C (WB)
2. T3 conditions: Indoor Air Temperatures 29°C (DB) / 19°C (WB) and Outdoor Air Temperatures 46°C (DB) / 24°C (WB)
* Recommended wire sizes are for reference & guidance only, all field wires should comply with National and International Electrical Codes
Carrier reserves the right to change features and/ or specifications without notice and without incurring any liability.



Cassette Type
42KTD



With non-ozone depleting refrigerant (R-410A)



Fresh air intake

A ventilation motor (no more than 200W) can be installed in the fresh air duct to increase the volume of fresh air.



Ideal performance

Carrier's range of condensing units guarantee continuous exceptional performance in extreme ambient conditions.



360° air flow

Ensures uniform temperature distribution around the entire room.



Built-in drain pump

Water condensation is easily drained with the unit's built-in drain pump, which allows for a drainage lift of up to 750mm.

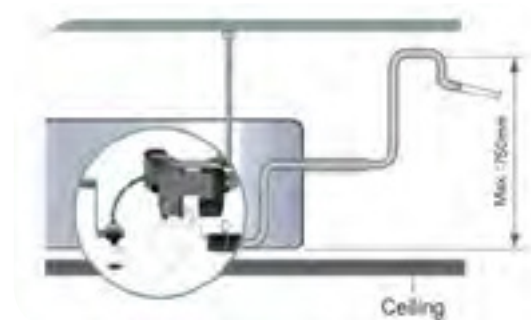

Easy to maintain drain pump

Improved structure makes it more convenient to repair the drain pump.

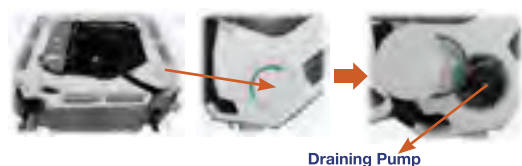

Independent vane control

Air flow direction can easily be changed for any room layout and each vane can be set independently as preferred through the wired controller.



Turbo mode

With this function, the air conditioner will maximize the output of cooling or heating capacity, make the room cool down or heat up rapidly, and attain the desired temperature in the shortest time.



Cost savings

The high efficiency compressor and the large condenser coil surface result in a reduction in energy use to provide cost savings.



Auto restart function

If the air conditioner shuts down unexpectedly due to a power cut, it will restart automatically with the previous setting mode when the power returns.



Timer function

Set the unit to start and stop automatically within a 24h period.



Quiet performance

The low noise compressor with quiet movement of air across the large condenser fan has made this unit a quiet preformer.



Sleep mode

This air conditioner will automatically increase or decrease the temperature by 1°C per hour for the first two hours, then hold it steady for the next 5 hours after which it will switch off. This function maintains both energy savings and comfort in the night.



Corrosion-resistant casing

The unit is built to last; its powder-coated metal parts and UV-resistance provide a strong protective armor from natural elements.



Independent dehumidification

Independent dehumidification mode efficiently dehumidifies the room without affecting the temperature.



Refrigerant leakage detection

The indoor unit will show error code "EC" or flash LEDs and stop automatically when refrigerant leakage is detected. This function can protect the compressor from damage from high temperatures due to refrigerant leakage.